



Model number

U-G1F

AS-Interface module mounting base for connection to flat cable (AS-Interface)

Function

The U-G1F lower section makes it possible to connect slaves from the G1 and G4 series to the AS-Interface without an additional power supply (EMS). It features two connections to the AS-Interface which are linked together. In this way it can serve as a distributor from one AS-Interface arm to another. When an upper section (module or VAZ-DK-G1 cover) is mounted, the flat cables are pressed into the insulation penetration blades, thus creating a contact.

Accessories

VAZ-DK-G1

Cover for bases -G1F- and -G1P-

Dimensions

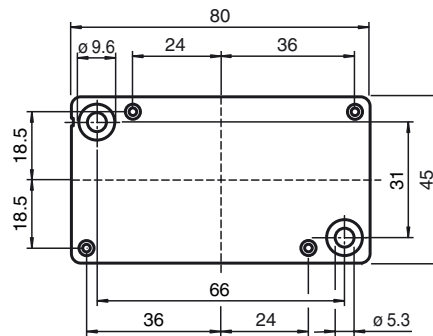

Electrical connection

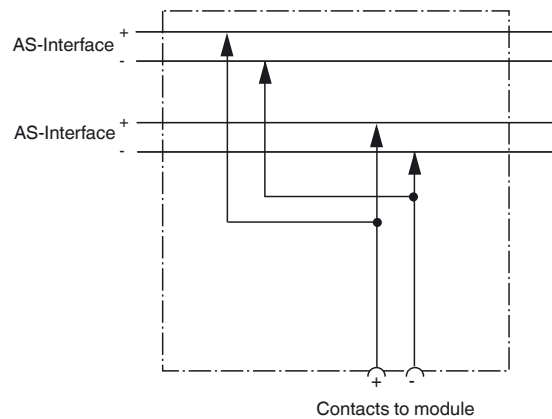

Technical data

General specifications

UL File Number	E223772
----------------	---------

Electrical specifications

Current loading capacity	≤ 2 A for max. 40 V
--------------------------	--------------------------

Ambient conditions

Ambient temperature	-25 ... 60 °C (-13 ... 140 °F)
Storage temperature	-25 ... 85 °C (-13 ... 185 °F)

Mechanical specifications

Degree of protection	IP67 according to EN 60529 (only in connection with module or cover)
Connection	2 AS-Interface flat cables
Material	
Housing	PBT
Dimensions	about 80, 45, 20 mm (L, W, H)
Mounting	DIN rail or screw mounting

Matching system components**VBA-4E-G4-Pt100**

G4 module IP65
4 inputs for Pt100

VAZ-T4-G1

Splitter box AS-Interface to 4x M12 round connector

VAA-4A-G1-R

Standard module IP67
4 relay outputs

VAA-4E-G4-ZE

G4 module IP67
4 inputs (PNP)

VAA-4E-G4-ZE-IFM

G4 module IP67
4 inputs (PNP)

VBA-4E-G4-ZE

G4 module IP67
4 inputs (PNP)

VAA-LT2-G1

Illuminated pushbutton module

VBA-LT2-G1

Illuminated pushbutton module

VBA-LT2-G1-Y

Illuminated pushbutton module

VAA-4E-G4-Z

G4 module IP67
4 inputs (2-wire)

VAA-2*2E-G1-AE

Standard module IP67
2 x 2 inputs (PNP)

VAA-4E-G1-ZE

Standard module IP67
4 inputs (PNP)

VAA-4E-G4-ZE0

G4 module IP67
4 inputs (NPN)

VAA-4E-G4-N

G4 module IP67
4 inputs (NAMUR)

VAA-2EA-G1-ZE/P-S

Pneumatic module
2 inputs/2 pneumatic outputs

VBA-4E2A-G1-ZE/P-S

Pneumatic module
4 inputs/2 pneumatic outputs

VAA-4E2A-G1-ZE/P-S

Pneumatic module
4 inputs/2 pneumatic outputs

VAA-2E-G4-SN

G4 PG module IP67
safety module with 2 inputs

VAA-2EA-G1-ZE/P-V2A

Pneumatic module
2 inputs/2 pneumatic outputs